

# SCULPTURE IN THE CITY FAMILY ACTIVITY

## ACTIVITY 13: DESIGN YOUR OWN SCULPTURE IN THE CITY!



# FACT SHEET

Show on screen or print

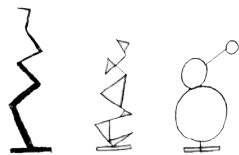
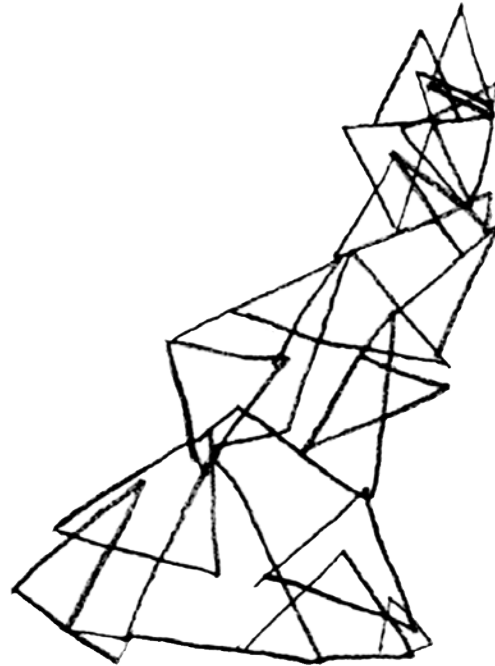
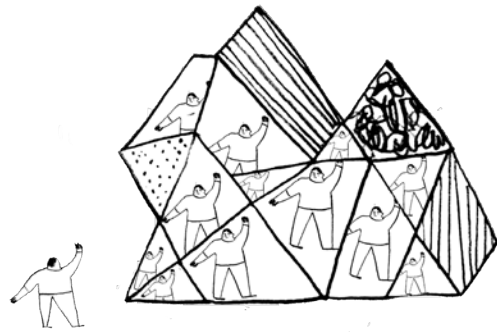

### Key information:

- Design a sculpture for St Helen's Square or under the 'Cheesegrater'.
- Look at the St Helen's Square Fact Sheet, and Map of the Area (slides 2 +3).
- Watch the 'introducing the task video' - click the icon on slide 4
- Activity 13A: Choose a sculpture location.
- Print activity sheet (slide 5)
- Please look at the photos of the 3 possible sites on screen (slides 6-8).
- Please refer to the guidance slides, 'Think like an Artist' on screen (slides 9-13).
- Choose the location of your sculpture!
- Activity 13B: Sketching initial ideas for your sculpture.
- Print the activity sheet for your chosen location (slides 14-16)
- Please refer to photos of St Helen's Square and it's surroundings for inspiration! (slides 18-22)
- Sketch your initial sculpture ideas!



## ST HELEN'S SQUARE

Show on screen or print



### Key information:

- St Helen's Square is the 3rd largest open public space in the City of London.
- It reopened with a new contemporary design in 2018.
- It has been transformed into a colourful and welcoming place where office workers and visitors can meet or relax and enjoy the unique surrounding buildings.
- There are curved stone seating areas and colourful plants that create spaces within the square for people to sit and enjoy it.
- It acts as a major route for people to easily walk between the important office buildings e.g. 'The Gherkin' and The Lloyds building.
- The square flows into the outdoor covered space under 'The Cheesegrater'.
- The old church, St Andrew Undershaft is named after the giant maypole (known as a shaft in medieval times) that used to stand next to it. The wooden pole was used in festivals and people danced around it.



# SCULPTUREINTHECITY

FAMILY ACTIVITY

# THE MAP!

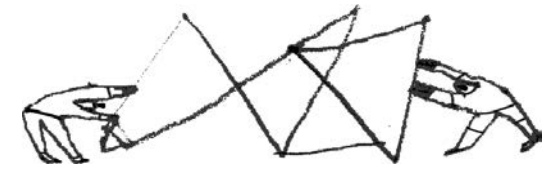

Show on screen

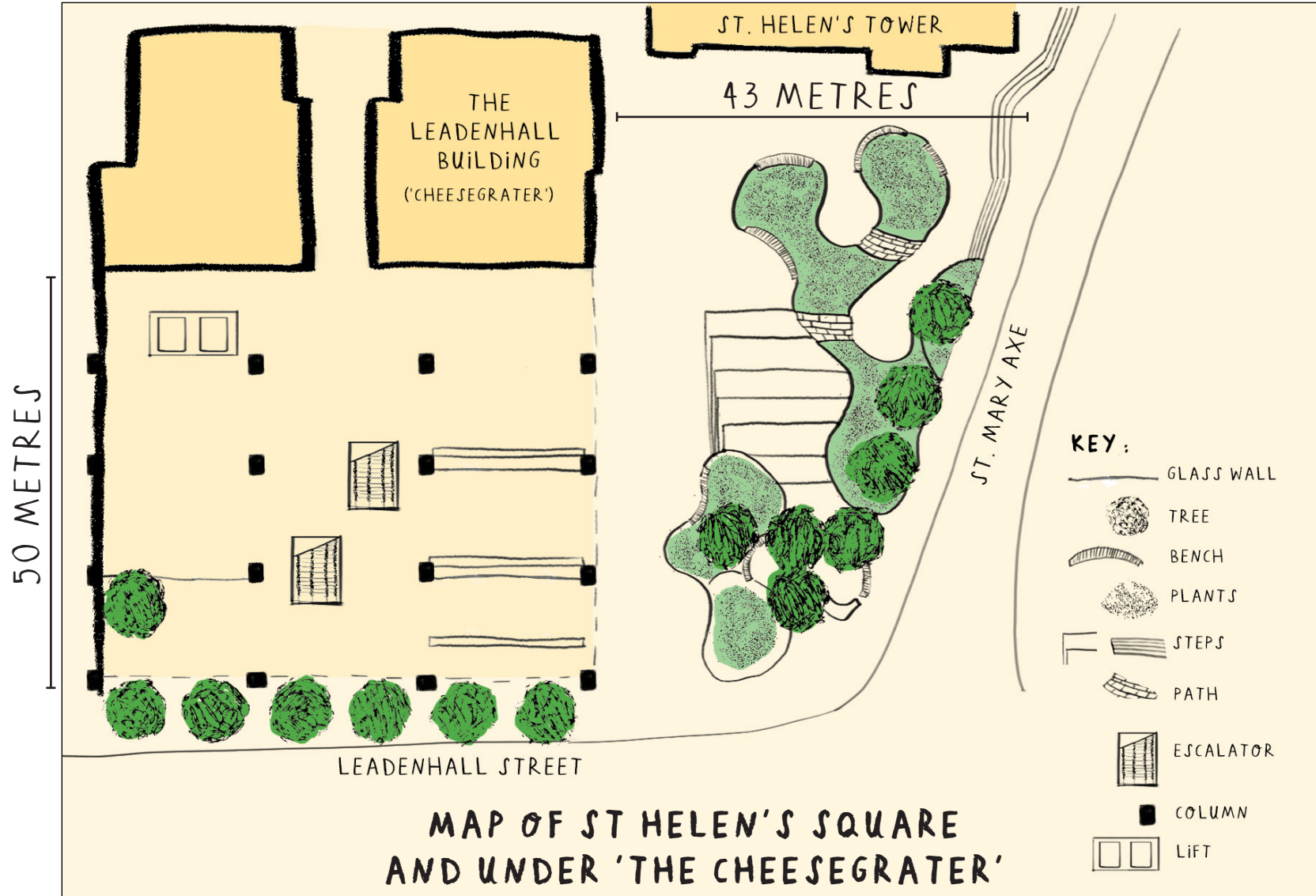

# SCULPTUREINTHECITY

FAMILY ACTIVITY

## INTRODUCING THE DESIGN TASK

click on the below icon to  
watch the video

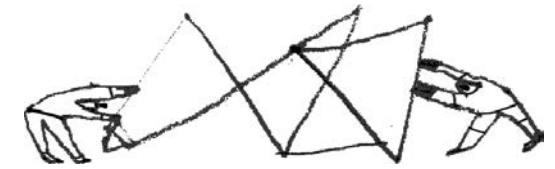

Show on screen



INTRODUCING THE DESIGN TASK

# SCULPTUREINTHECITY FAMILY ACTIVITY

## ACTIVITY 13A: CHOOSE A SCULPTURE LOCATION

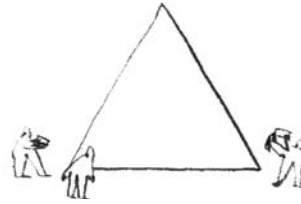

### INSTRUCTIONS:

- Look at the map of St Helen's Square and the 3 possible sites for your sculpture to be placed.
- Look at the photos of the 3 possible sites (slides 6-8) and the 'Think like an Artist' slides - especially 'context' (9-13).
- Read the reasons for and against placing your sculpture there. Tick the corresponding box for your

#### Site 1:

- Lots of people walk past.
- It is not sheltered from the wind or rain.
- It can be seen from many directions.
- It is near the steps.

Tick this box if this is your chosen site.

#### Site 2:

- It is in a green space and surrounded by planters.
- It is a smaller and more private space.
- It is not sheltered from the wind or rain.
- It is opposite the entrance to St Helen's Tower.

Tick this box if this is your chosen site.

#### Site 3:

- Lots of people walk past.
- It is sheltered from the rain.
- It can be seen from most places in the Square.

Tick this box if this is your chosen site.

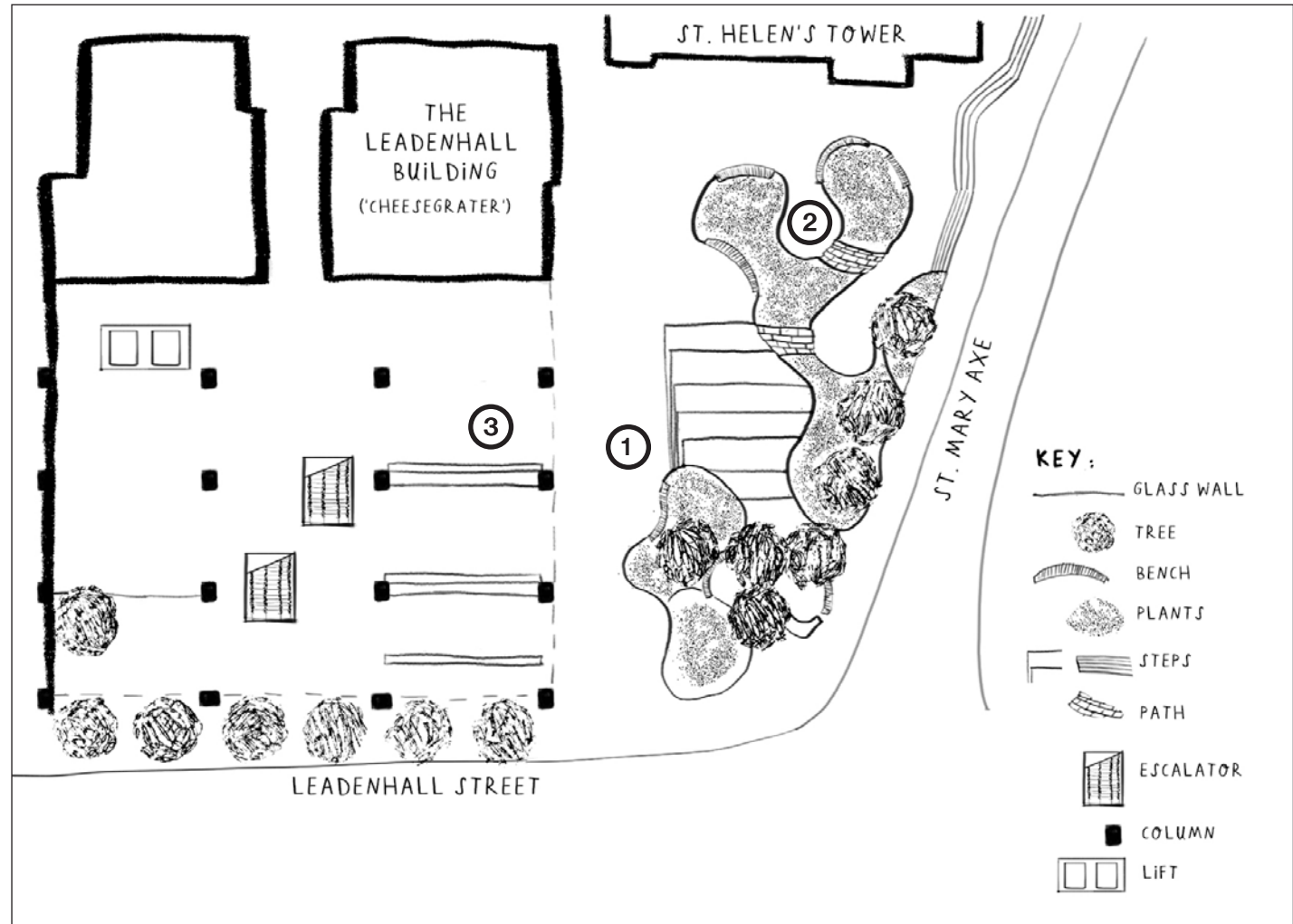



# SCULPTURE IN THE CITY

FAMILY ACTIVITY

TOOLKIT: ACTIVITY 13A

## SITE 1

### SITE INFORMATION:

- Lots of people walk past.
- It is not sheltered from the wind or rain.
- It can be seen from many directions.
- It is near the steps.

Show on screen or print

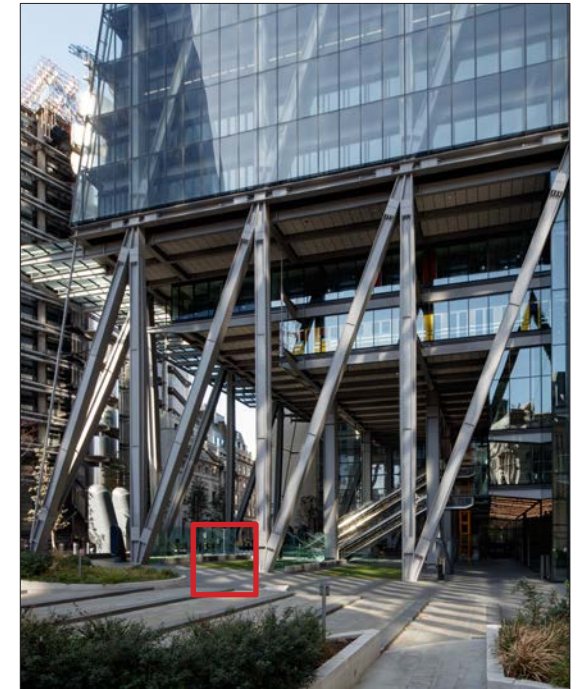
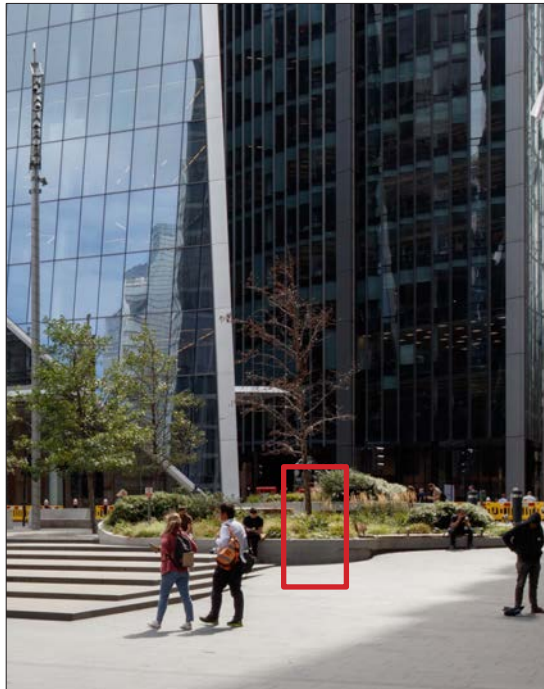

# SCULPTURE IN THE CITY

FAMILY ACTIVITY

TOOLKIT: ACTIVITY 13A

## SITE 2

### SITE INFORMATION:

- It is in a green space and surrounded by planters.
- It is a smaller and more private space.
- It is not sheltered from the wind or rain.
- It is opposite the entrance to St Helen's Tower.

Show on screen or print

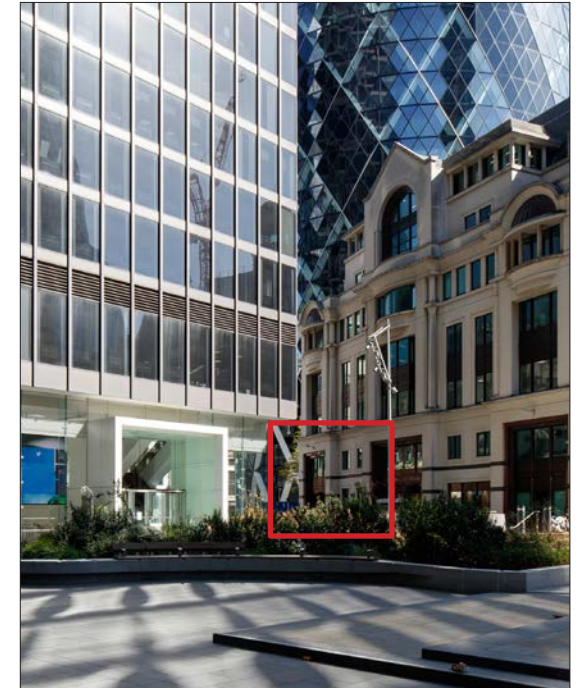
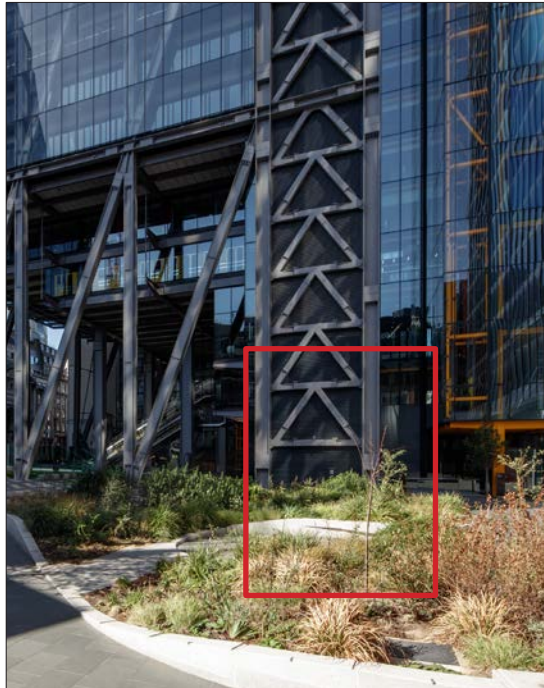
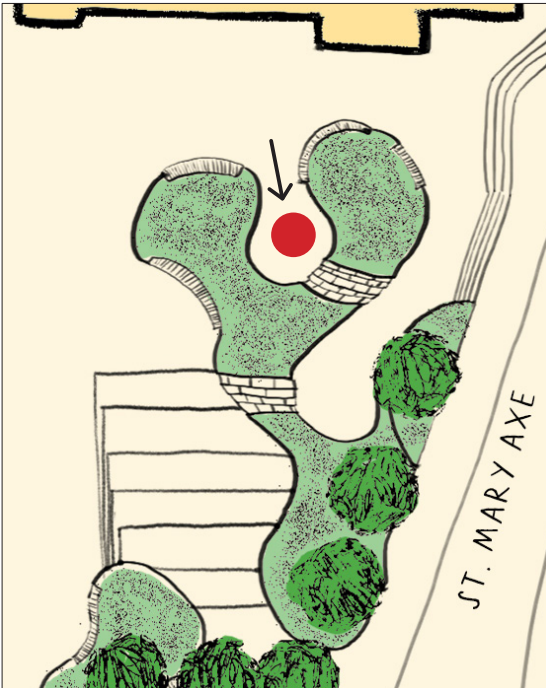

The site is behind the plants!



# SCULPTURE IN THE CITY

FAMILY ACTIVITY

TOOLKIT: ACTIVITY 13A

## SITE 3

### SITE INFORMATION:

- Lots of people walk past.
- It is sheltered from the rain.
- It can be seen from most places in the Square.

Show on screen or print

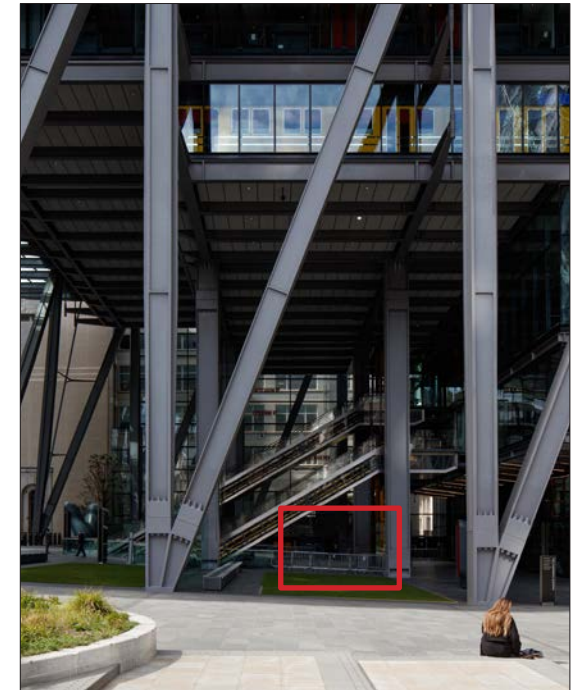
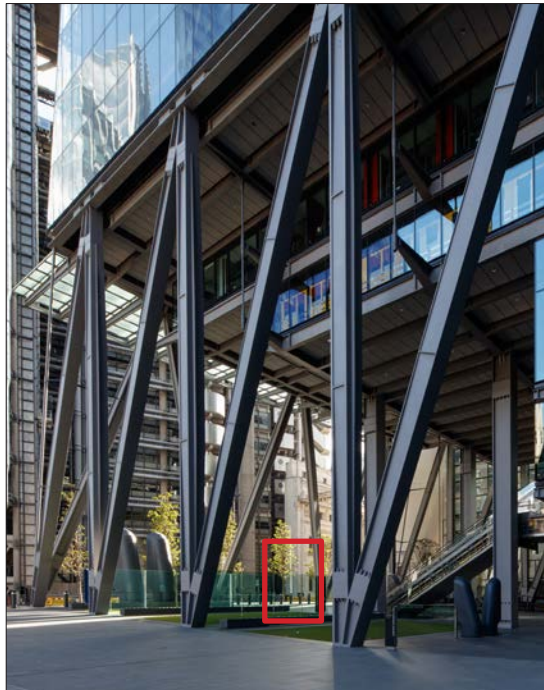
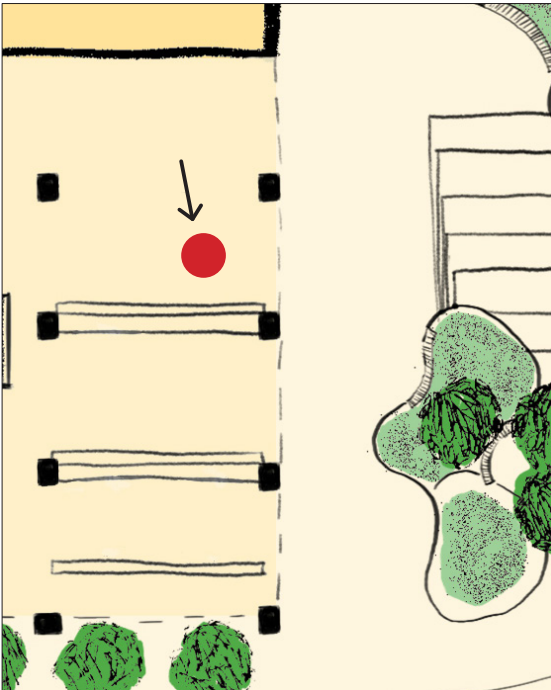



# SCULPTURE IN THE CITY

FAMILY ACTIVITY

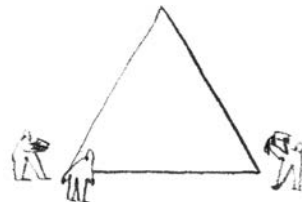

Show on screen

LET'S THINK LIKE AN ARTIST  
AND EXPLORE IMPORTANT  
THEMES TO CONSIDER WHEN  
DESIGNING..

## 1. CONTEXT



Show on screen

THE LOCATION YOUR SCULPTURE WILL GO IN IS IMPORTANT...

So you will need to think about:

- What is nearby the location? e.g. buildings, trees or benches
- Is the location open or hidden? e.g. can it be seen from other areas of the Square?
- Is the area sheltered from rain or wind?



← What buildings are nearby?

← People often walk past!



## 2. SCALE



Show on screen

THE SIZE AND SCALE OF YOUR SCULPTURE IS

So you will need to think about:

- The size of the sculpture in relation to what is nearby.
- if the sculpture fits in it's location?
- Is it bigger or smaller than you?



Look at the size of the people compared to the buildings around them!



## 3. MATERIALS

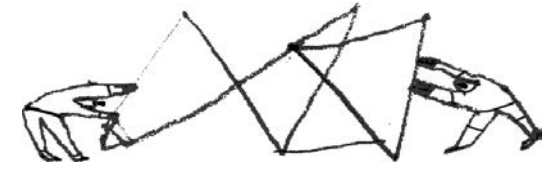

Show on screen

THE MATERIALS USED IS IMPORTANT...

So you will need to think about:

- What your sculpture made from.
- Are the materials similar or different to the materials found in St Helen's Square? e.g. metal or glass
- Think about the colours and textures of materials too!  
Metal and wood can be painted!

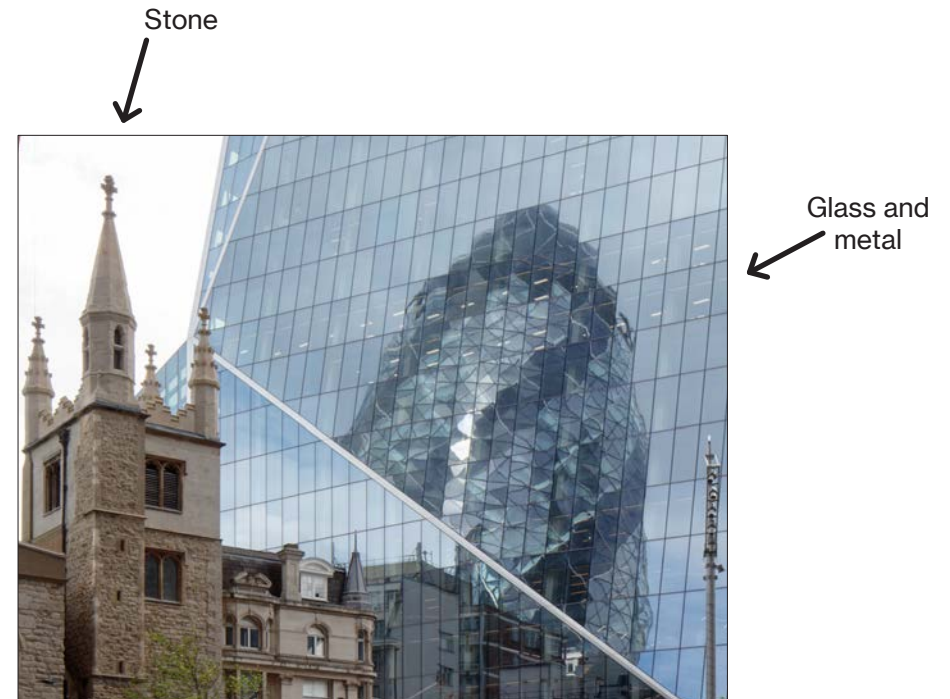



## 4. FORM

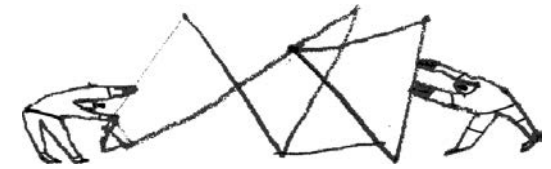

Show on screen

THE SHAPE OF YOUR SCULPTURE IS IMPORTANT...

So you will need to think about:

- What 3D shape or shapes do you want your artwork to be?  
Is it curvy or have straight lines?
- Is the shape inspired by the buildings in St Helen's Square?
- It can be as abstract and fun as you want!



There are lots of  
straight lines too!

Look at the curved  
shapes on the  
different buildings!

# SCULPTURE IN THE CITY FAMILY ACTIVITY

## ACTIVITY 13B: SKETCHING INITIAL SCULPTURE IDEAS

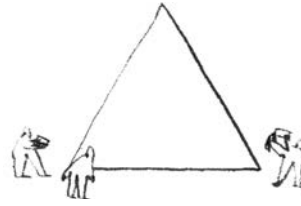

### INSTRUCTIONS:

- Look again at 'Think like an Artist' slides and at the following slides on screen to help you come up with initial sculpture ideas.
- Read the key information about your chosen site.
- Look at the drawing of your site and the proportion of the person. What size will your sculpture be?
- Sketch initial ideas for your sculpture!

### SITE 1

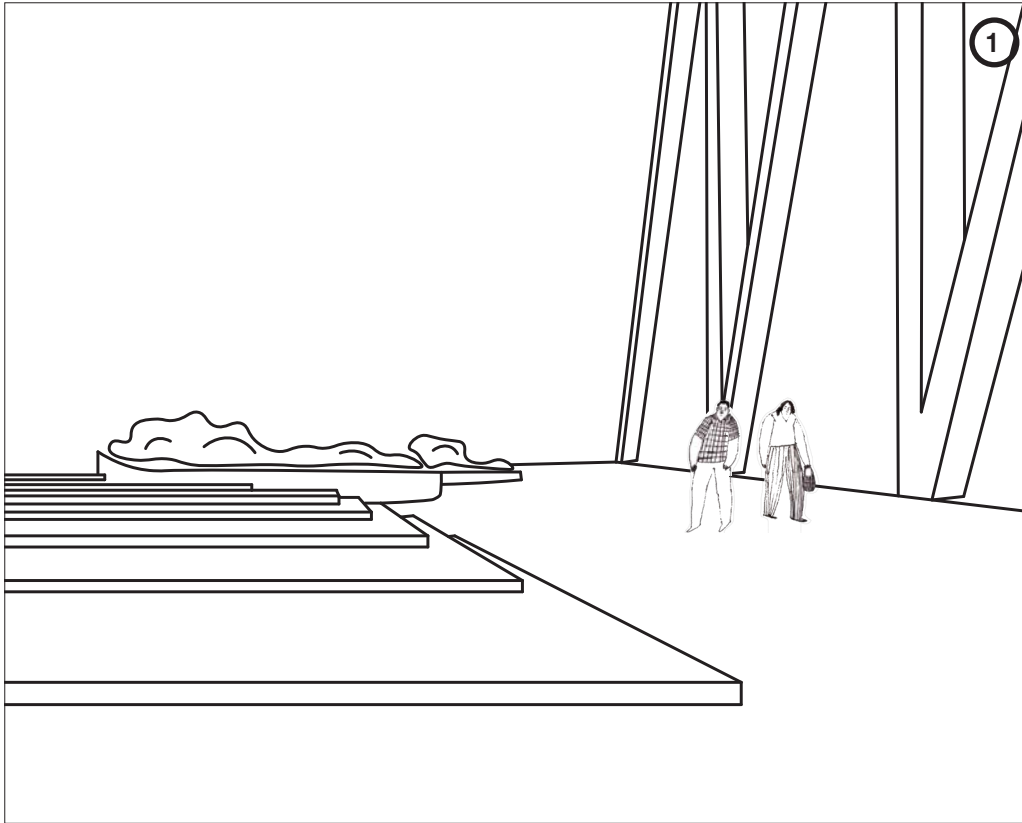

**Drawing Space:** Use more scrap paper if you need it. You could also sketch your sculpture idea on the drawing of the site!



#### Key information:

- Lots of people walk past.
- It is not sheltered from the wind or rain.
- It can be seen from many directions.
- It is near the steps.

What materials will your sculpture be made from?

- \_\_\_\_\_
- \_\_\_\_\_
- \_\_\_\_\_





# SCULPTURE IN THE CITY FAMILY ACTIVITY

## ACTIVITY 13B: SKETCHING INITIAL SCULPTURE IDEAS

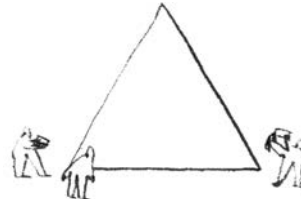

### INSTRUCTIONS:

- Look again at 'Think like an Artist' slides and at the following slides on screen to help you come up with initial sculpture ideas.
- Read the key information about your chosen site.
- Look at the drawing of your site and the proportion of the person. What size will your sculpture be?
- Sketch initial ideas for your sculpture!

### SITE 2

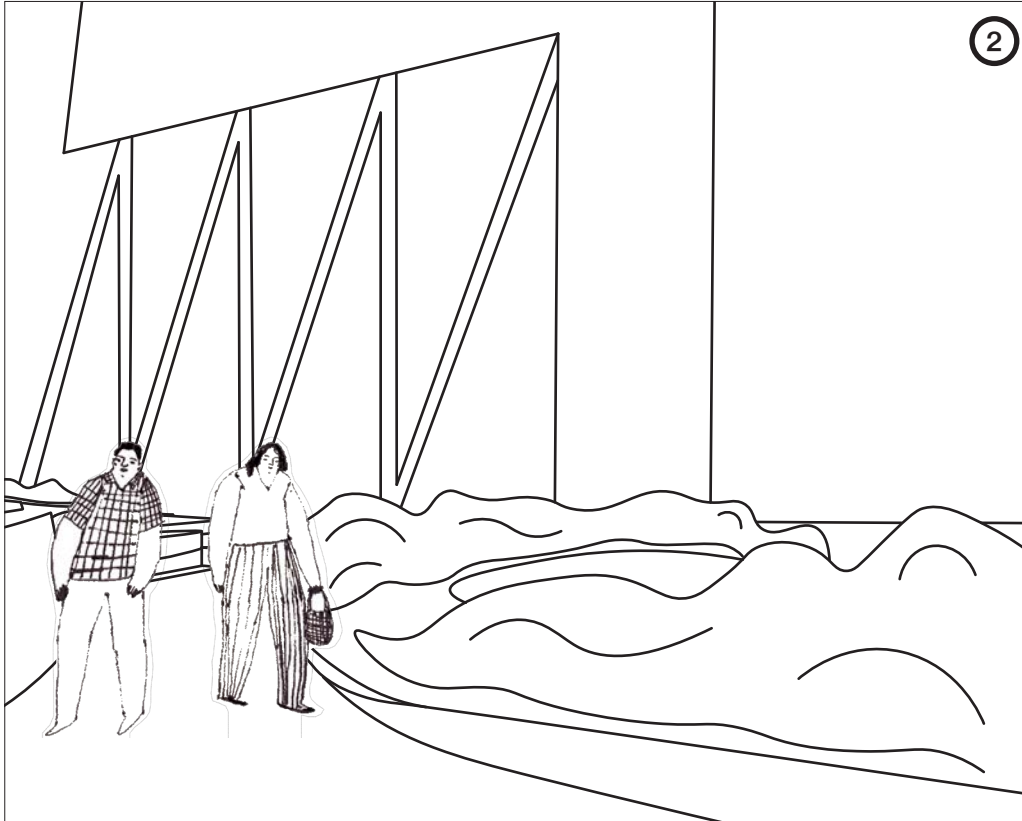

#### Key information:

- It is in a green space and surrounded by planters.
- It is a smaller and more private space.
- It is not sheltered from the wind or rain.

What materials will your sculpture be made from?

- \_\_\_\_\_
- \_\_\_\_\_
- \_\_\_\_\_

**Drawing Space:** Use more scrap paper if you need it. You could also sketch your sculpture idea on the drawing of the site!



# SCULPTURE IN THE CITY FAMILY ACTIVITY

## ACTIVITY 13B: SKETCHING INITIAL SCULPTURE IDEAS

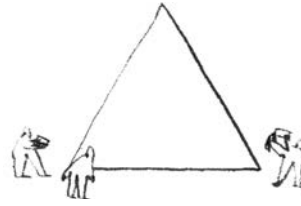

### INSTRUCTIONS:

- Look again at 'Think like an Artist' slides and at the following slides on screen to help you come up with initial sculpture ideas.
- Read the key information about your chosen site.
- Look at the drawing of your site and the proportion of the person. What size will your sculpture be?
- Sketch initial ideas for your sculpture!

### SITE 3

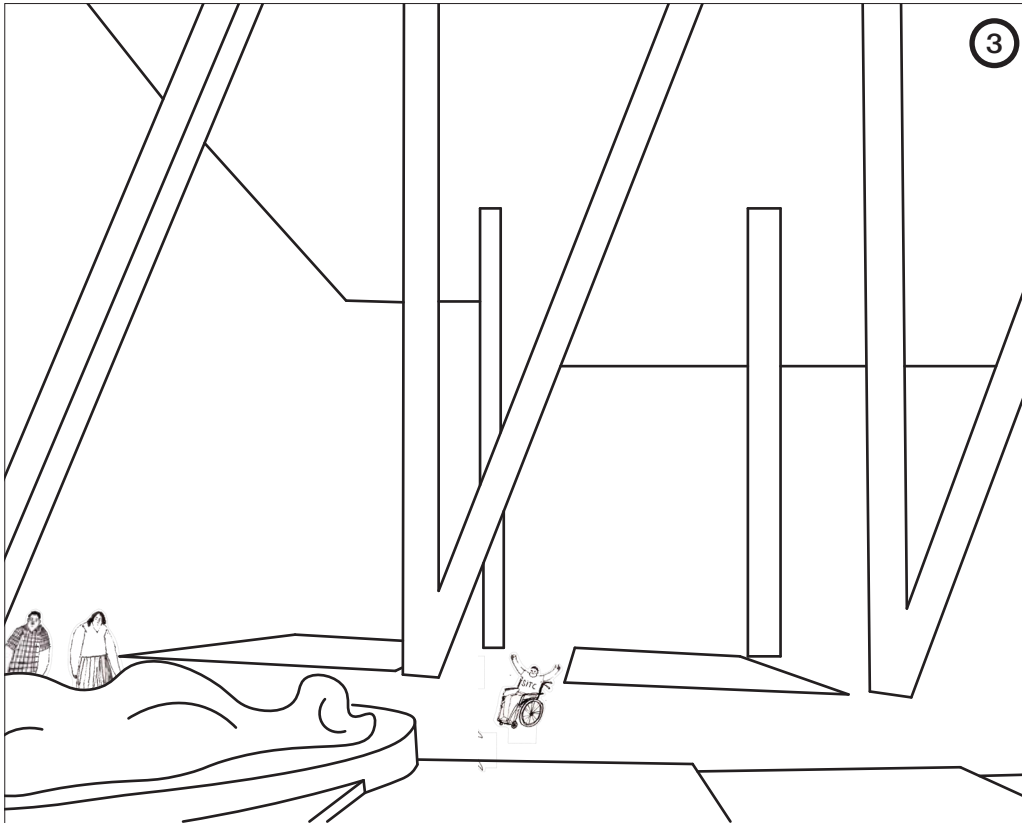

#### Key information:

- Lots of people walk past.
- It is sheltered from the rain.
- It can be seen from most places in the Square.

What materials will your sculpture be made from?

- \_\_\_\_\_
- \_\_\_\_\_
- \_\_\_\_\_

**Drawing Space:** Use more scrap paper if you need it. You could also sketch your sculpture idea on the drawing of the site!



# SCULPTUREINTHECITY

FAMILY ACTIVITY

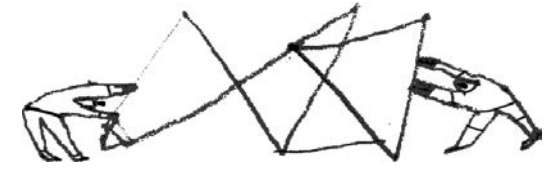
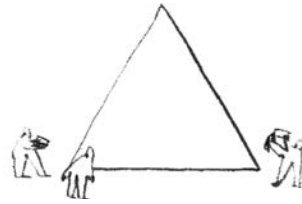

Show on screen

## WHAT SIZE DO YOU WANT YOUR SCULPTURE TO BE?



SMALL?



MEDIUM?



LARGE?

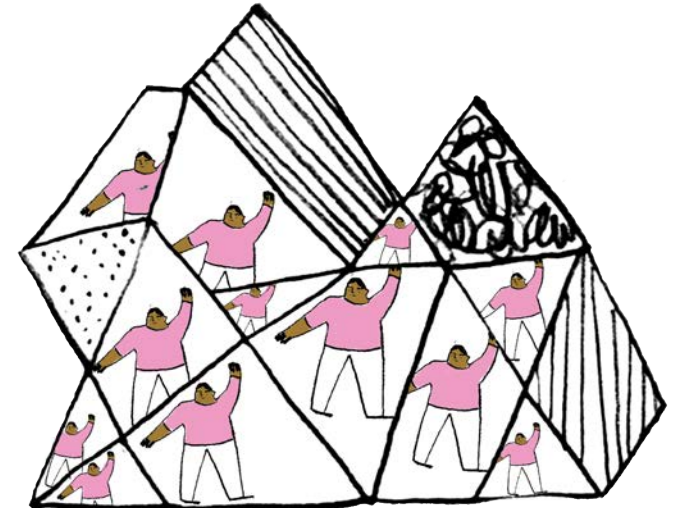



# SCULPTUREINTHECITY

FAMILY ACTIVITY

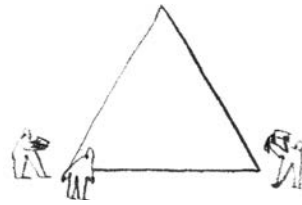

Show on screen

WHAT CAN INSPIRE YOUR SCULPTURE  
DESIGN FOR  
ST HELEN'S SQUARE?

LET'S HAVE ANOTHER LOOK AT THE  
SQUARE AND IT'S SURROUNDINGS AND  
SEE IF ANYTHING THERE INSPIRES YOU.....

# SCULPTUREINTHECITY

FAMILY ACTIVITY

## VIEW OF ST HELEN'S SQ.

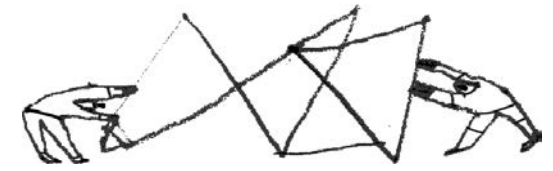

Show on screen

LOOK AT THE  
INCREDIBLE  
SHADOWS ON  
THE FLOOR  
CREATED  
BY THE  
BUILDINGS!

WHAT  
SHAPES CAN  
YOU SEE?



ST HELEN'S  
SQUARE HAS  
A MIXTURE  
OF OLDER  
AND NEW  
BUILDINGS



# SCULPTUREINTHECITY

FAMILY ACTIVITY

## VIEW OF ST HELEN'S SQ.

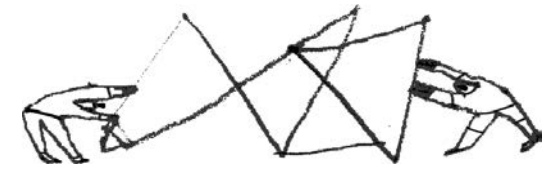

Show on screen

THE  
SKY SCRAPERS  
STAND TALL  
ABOVE THE  
SQUARE AND  
THE CHURCH!



WHAT  
MATERIALS  
CAN YOU  
SEE?



# SCULPTUREINTHECITY

FAMILY ACTIVITY

## VIEW OF ST HELEN'S SQ.

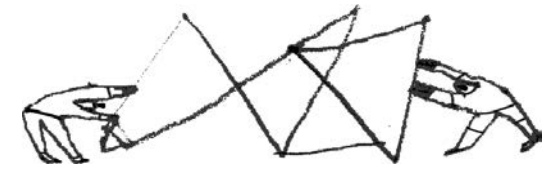

Show on screen

LOOK AT HOW  
THE SQUARE  
IS CONNECTED  
TO THE AREA  
UNDER 'THE  
CHEESE  
GRATER'



WHAT  
SHAPES CAN  
YOU SEE?

# SCULPTUREINTHECITY

FAMILY ACTIVITY

## VIEW OF ST HELEN'S SQ.

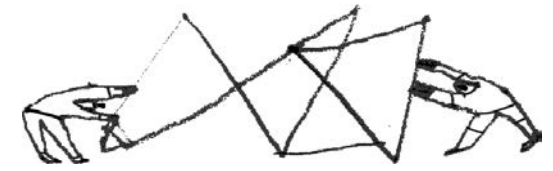

Show on screen

LOOK AT THE  
REFLECTIONS  
ON THE  
GLASS!



WHAT  
SHAPES CAN  
YOU SEE?